

# West Burton Solar Project

## Public Rights of Way Plan Revision B – Change Application Version

Prepared by: Lanpro Services  
January 2024

PINS reference: EN010132  
Document reference: CR1/WB2.4\_B  
APFP Regulation 5(2)(k)



## Schedule of Changes

Figure Reference	Page	Description of Changes	Reason for Revision
All sheets	3-13	Updates to annotations and title block	For presentational clarity.
Index Sheet	3	Order limits and relevant Works packages revised	Presentation of changes to Order Limits as applied for in <b>Change Request Application [EN010132/CR1/WB9.2]</b> .
Sheet 1 of 10	4	Extension of Order Limits	Presentation of Order Limit Change 1
Sheet 5 of 10	8	Extension of Order Limits	Presentation of Order Limit Change 2
Sheet 6 of 10	9	Extension of Order Limits	Presentation of Order Limit Change 3
Sheet 7 of 10	10	Extension of Order Limits	Presentation of Order Limit Change 4
Sheet 10 of 10	13	Extension of Order Limits	Presentation of Order Limit Change 5

- Key**
- Order Limits
  - Sheet Index
  - Potential PROW Diversion Area
  - Public Right of Way (PROW)
  - Footpath
  - Bridleway
  - Byway
  - Byway Open to All Traffic
  - PROW to be temporarily stopped up
  - Footpath
  - Bridleway
  - Byway
  - Byway Open to All Traffic

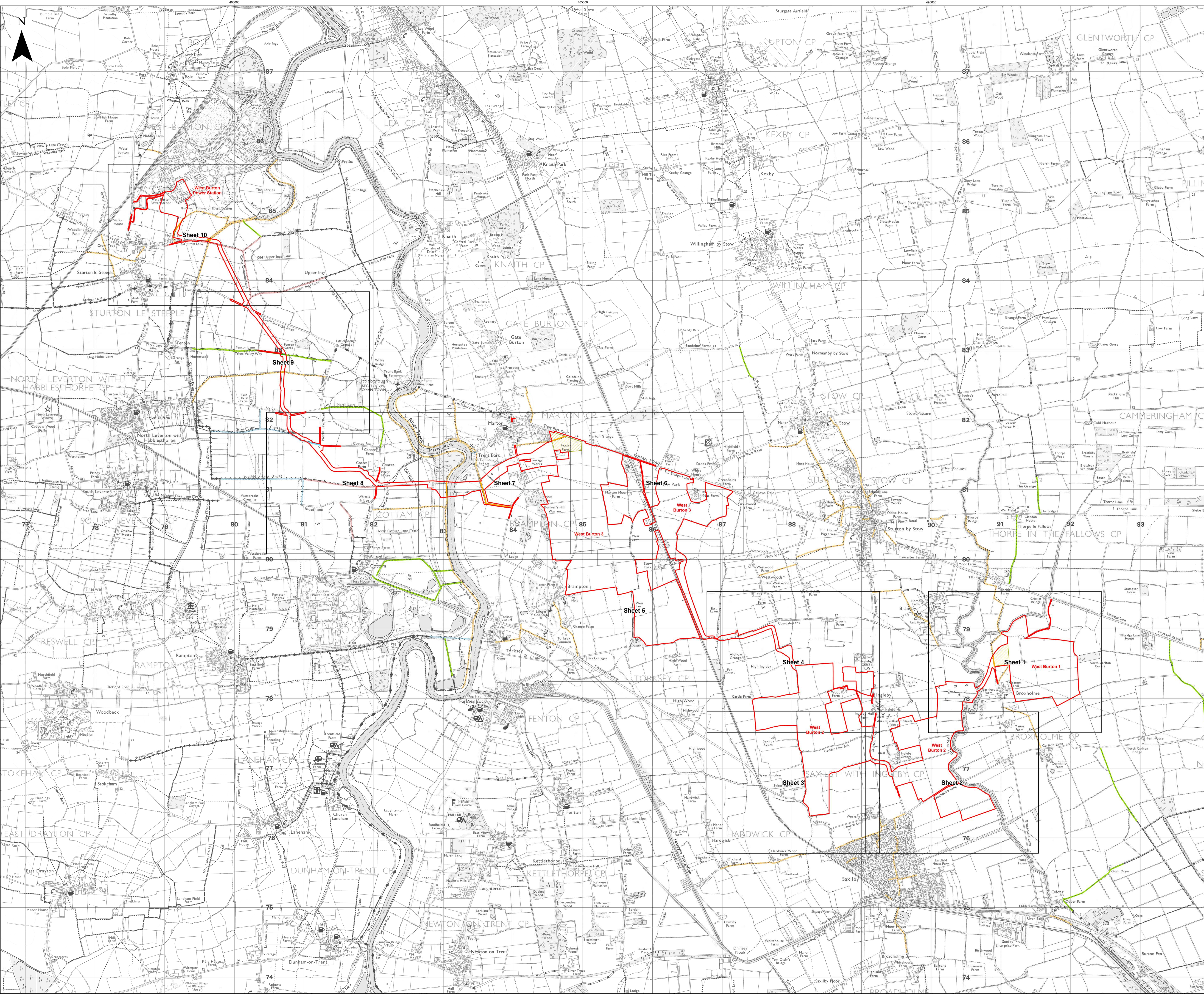

Layers: Lincolnshire County Council, 2024; Nottinghamshire County Council, 2024; North Lincolnshire County Council, 2024; Lanpro, 2024; IGD, 2024  
 Base map: Reproduced from Ordnance Survey digital map data © Crown copyright 2024. All rights reserved. License number 0100031673

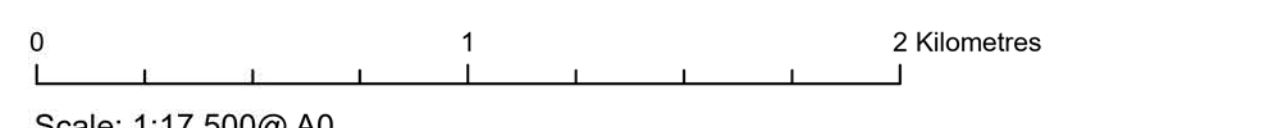

Scale: 1:17,500@A0

APPP Regulation: 5(2)(k)	Application Doc No. CR1/WB2.4_A
Ref: P2983_LPR_ZZ_ON_DR_Z_0209	Date: 19/01/2024
Drawn by: AZ	Checked by: JC

**Public Rights of Way Plan  
(Change Request Version)**  
Index Sheet

**WEST BURTON SOLAR PROJECT**

- Key**
- Order Limits
  - Sheet Index
  - Civil Parish Boundary
  - Potential PRoW Diversion Area
  - Public Right of Way (PRoW)**
  - Footpath
  - PRoW to be temporarily stopped up**
  - Footpath
  - PRoW to be temporarily stopped up - start and end points**
  - Footpath

Layers: Lincolnshire County Council, 2024; Nottinghamshire County Council, 2024; North Lincolnshire County Council, 2024; Lanpro, 2024; IGI, 2024  
 Base map: reproduced from Ordnance Survey digital map data © Crown copyright 2024. All rights reserved. Licence number 0100031673

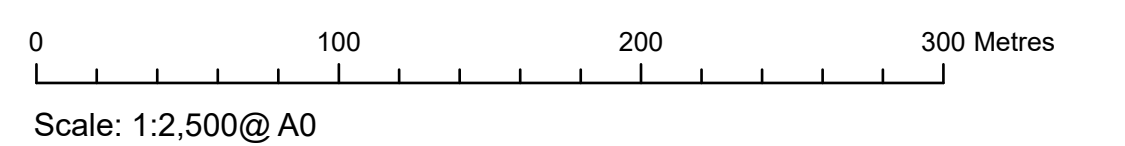

APFP Regulation: 5(2)(k)	Application Doc No. CR1/WB2.4_A
Ref: P2963_LPR_ZZ_ON_DR_Z_0210	Date: 19/01/2024
Drawn by: AZ	Checked by: JC

**Public Rights of Way Plan  
 (Change Request Version)**  
 Sheet 1 of 10

**WEST BURTON SOLAR PROJECT**

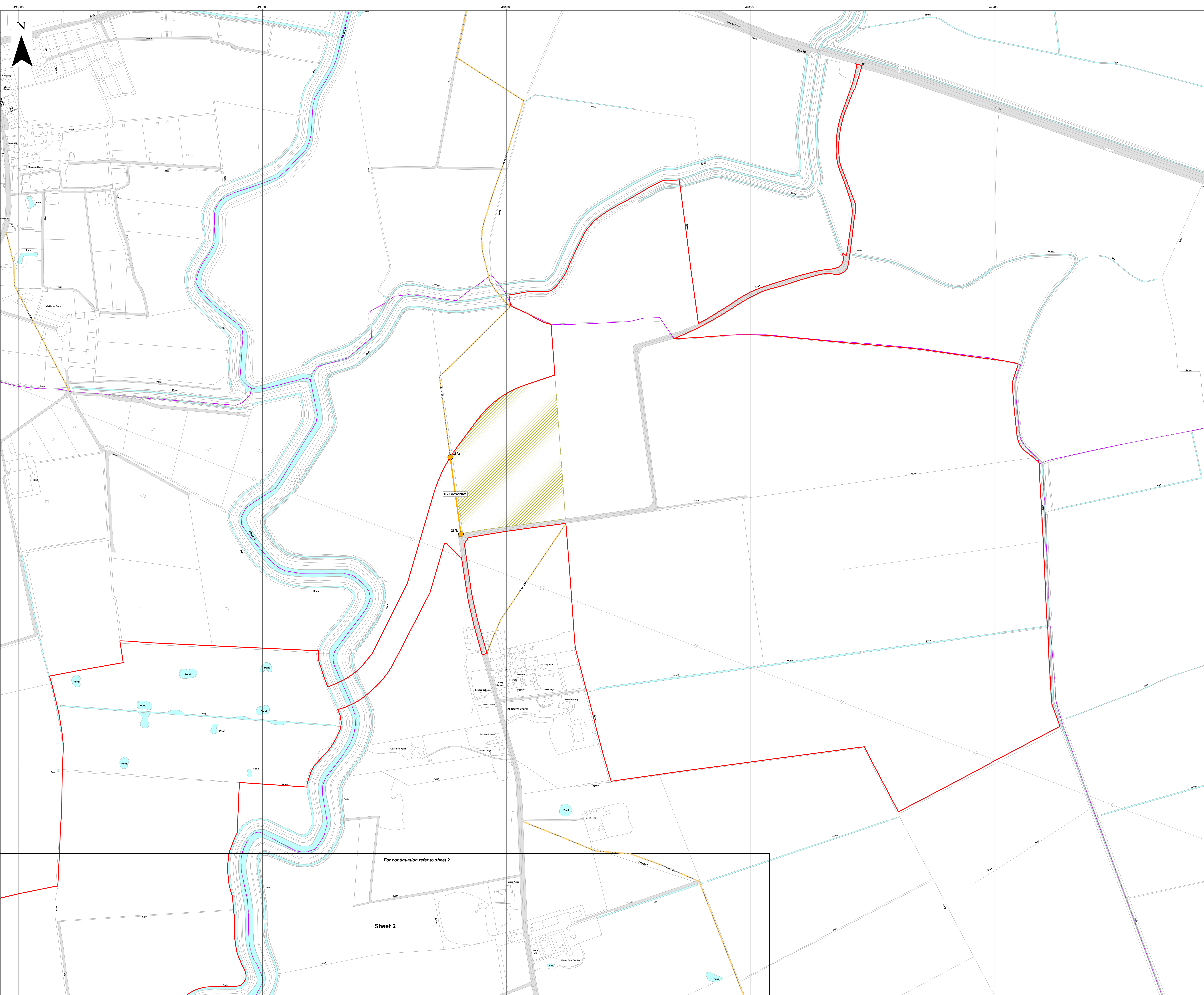

For continuation refer to sheet 2

Sheet 2

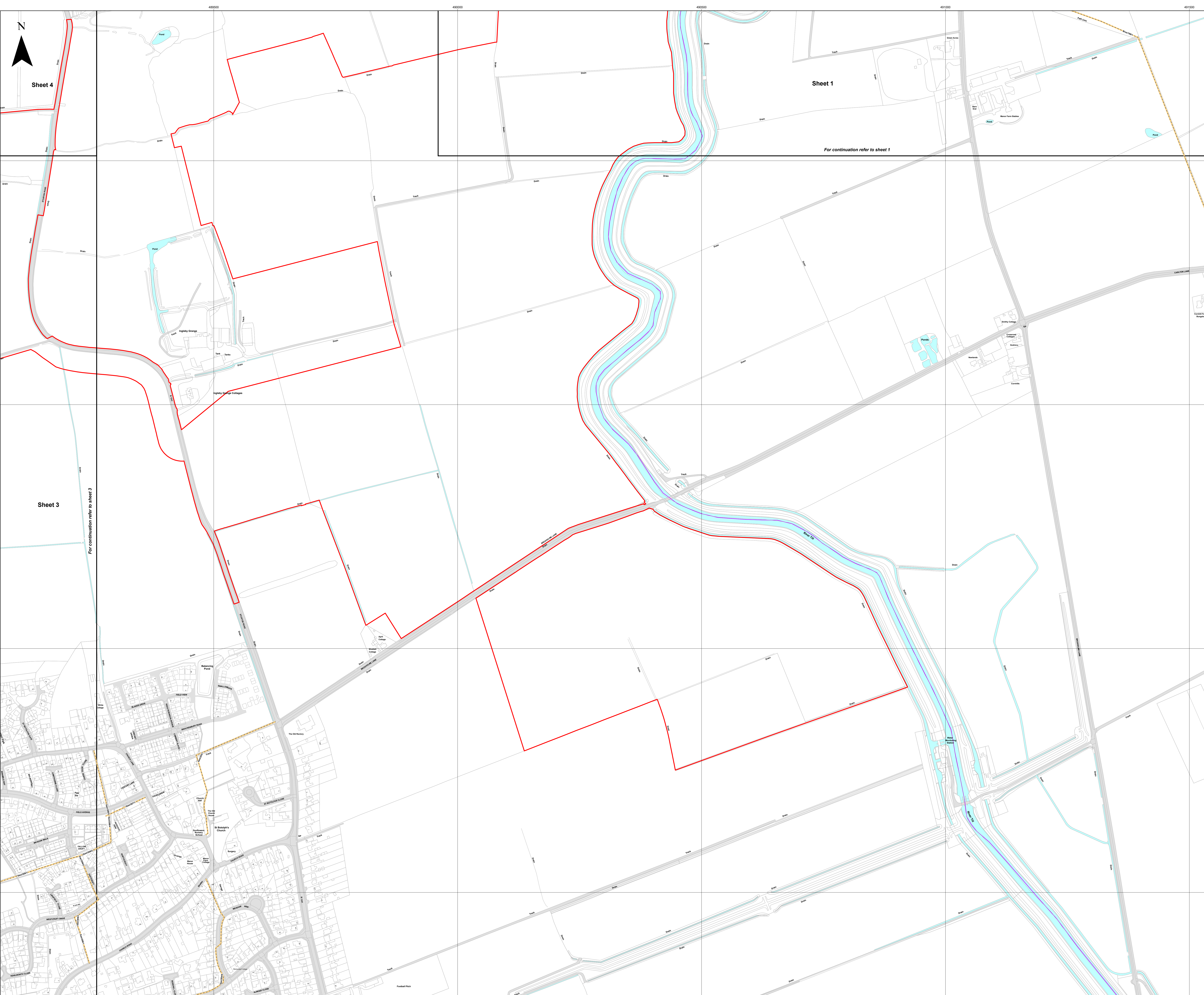

- Key**
- Order Limits
  - Sheet Index
  - Civil Parish Boundary
  - Potential PRow Diversion Area
  - Public Right of Way (PRow)
  - Footpath

Layers: Lincolnshire County Council, 2024; Nottinghamshire County Council, 2024; North Lincolnshire County Council, 2024; Lanpro, 2024; IGI, 2024  
Base map: reproduced from Ordnance Survey digital map data © Crown copyright 2024. All rights reserved. License number 0100031673

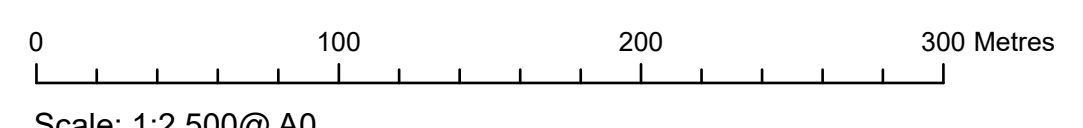

Scale: 1:2,500@A0

APFP Regulation: 5(2)(k)	Application Doc No. CR1/WB2.4_A
Ref: P2963_LPR_ZZ_ON_DR_Z_0210	Date: 19/01/2024
Drawn by: AZ	Checked by: JC

**Public Rights of Way Plan  
(Change Request Version)**  
Sheet 2 of 10

**WEST BURTON SOLAR PROJECT**

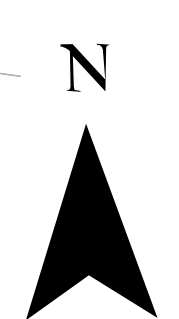
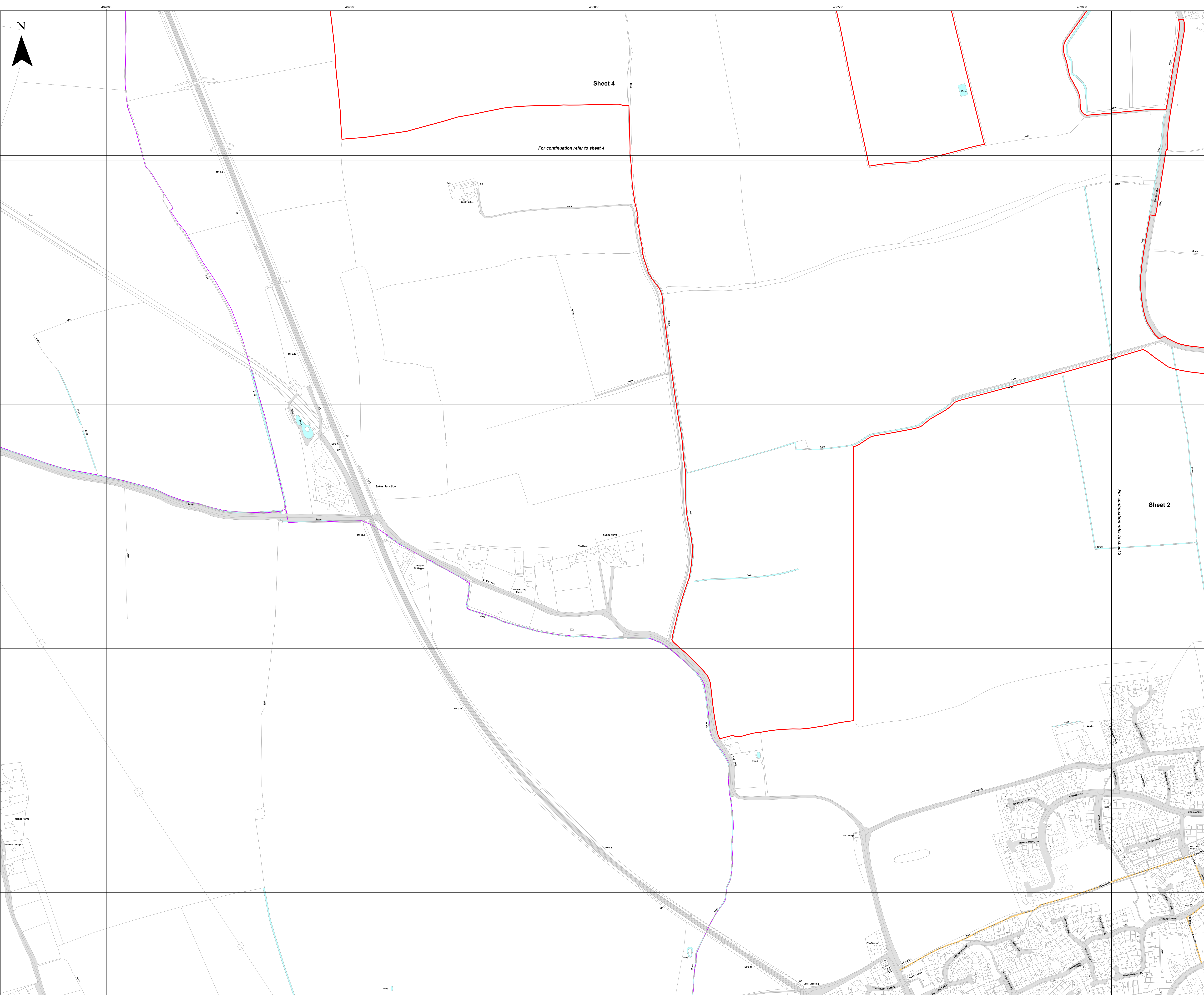

**Key**

- Order Limits
- Sheet Index
- Civil Parish Boundary
- Potential PRow Diversion Area
- Public Right of Way (PRow)
- Footpath

Layers: Lincolnshire County Council, 2024; Nottinghamshire County Council, 2024; North Lincolnshire County Council, 2024; Lanpro, 2024; IGI, 2024  
Base map: Reproduced from Ordnance Survey digital map data © Crown copyright 2024. All rights reserved. License number 0100031673

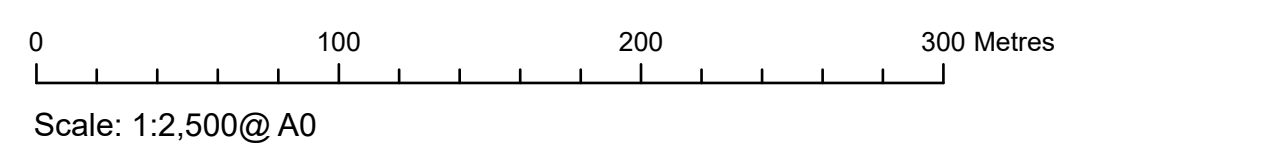

APFP Regulation: 5(2)(k)	Application Doc No. CR1/WB2.4_A
Ref: P2963_LPR_ZZ_ON_DR_Z_0210	Date: 19/01/2024
Drawn by: AZ	Checked by: JC

**Public Rights of Way Plan  
(Change Request Version)**  
Sheet 3 of 10

**WEST BURTON SOLAR PROJECT**

- Key**
- Order Limits
  - Sheet Index
  - Civil Parish Boundary
  - Potential PFI(W) Diversion Area
  - Public Right of Way (PROW)
  - Footpath

Layers: Lincolnshire County Council, 2024; Nottinghamshire County Council, 2024; North Lincolnshire County Council, 2024; Lanpro, 2024; IGI, 2024  
Base map: Reproduced from Ordnance Survey digital map data © Crown copyright 2024. All rights reserved. License number 0100031673

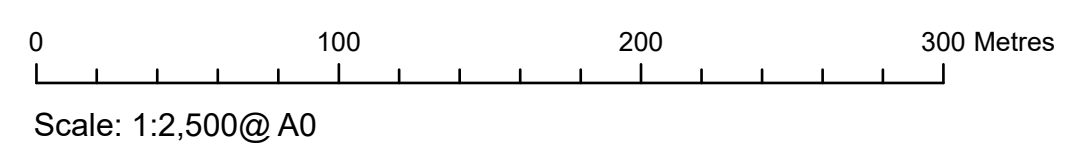

APFP Regulation: 5(2)(k)	Application Doc No. CR1/WB2.4_A
Ref: P2963_LPR_ZZ_ON_DR_Z_0210	Date: 19/01/2024
Drawn by: AZ	Checked by: JC

**Public Rights of Way Plan  
(Change Request Version)**  
Sheet 4 of 10

**WEST BURTON SOLAR PROJECT**

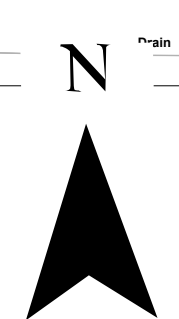
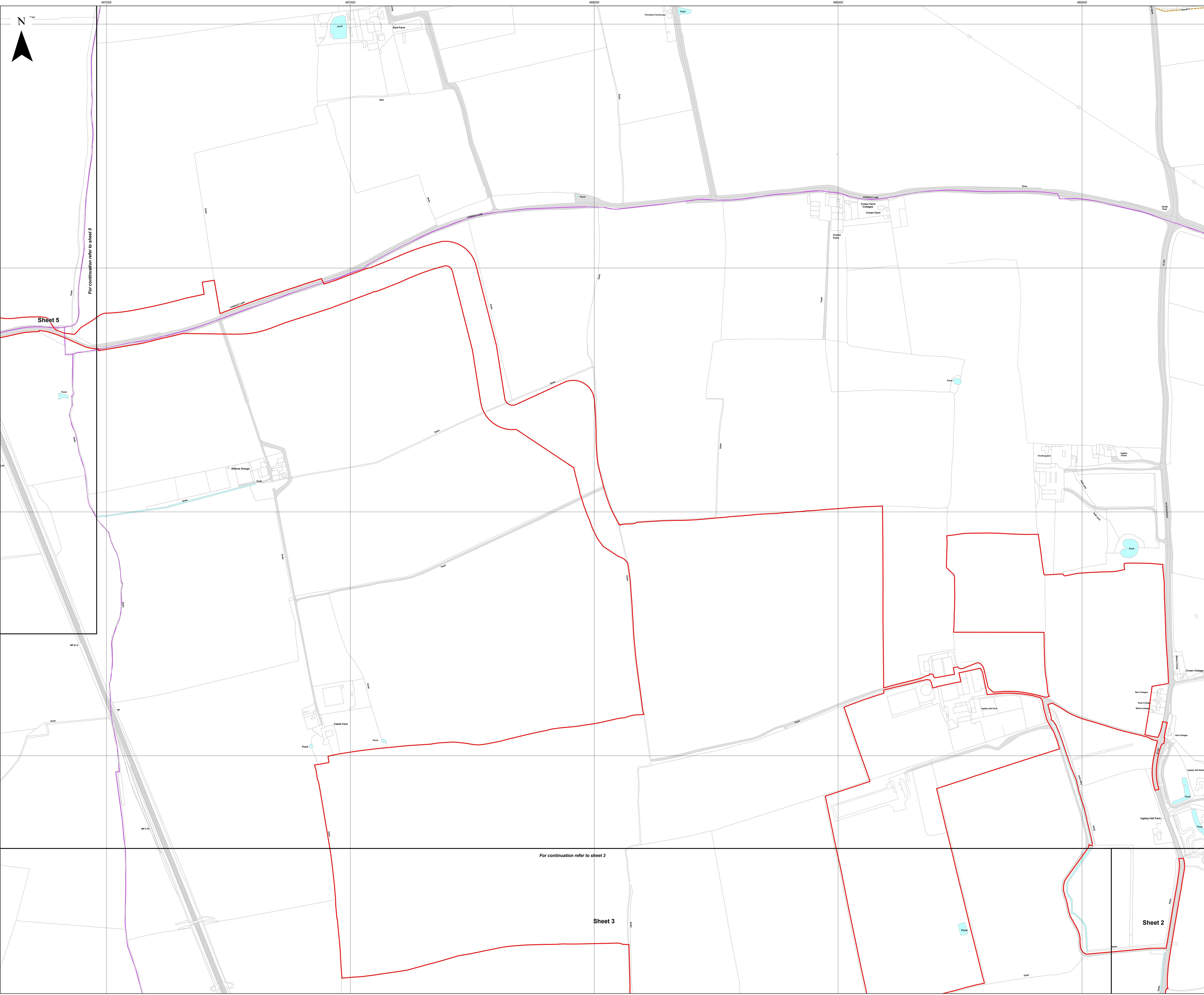

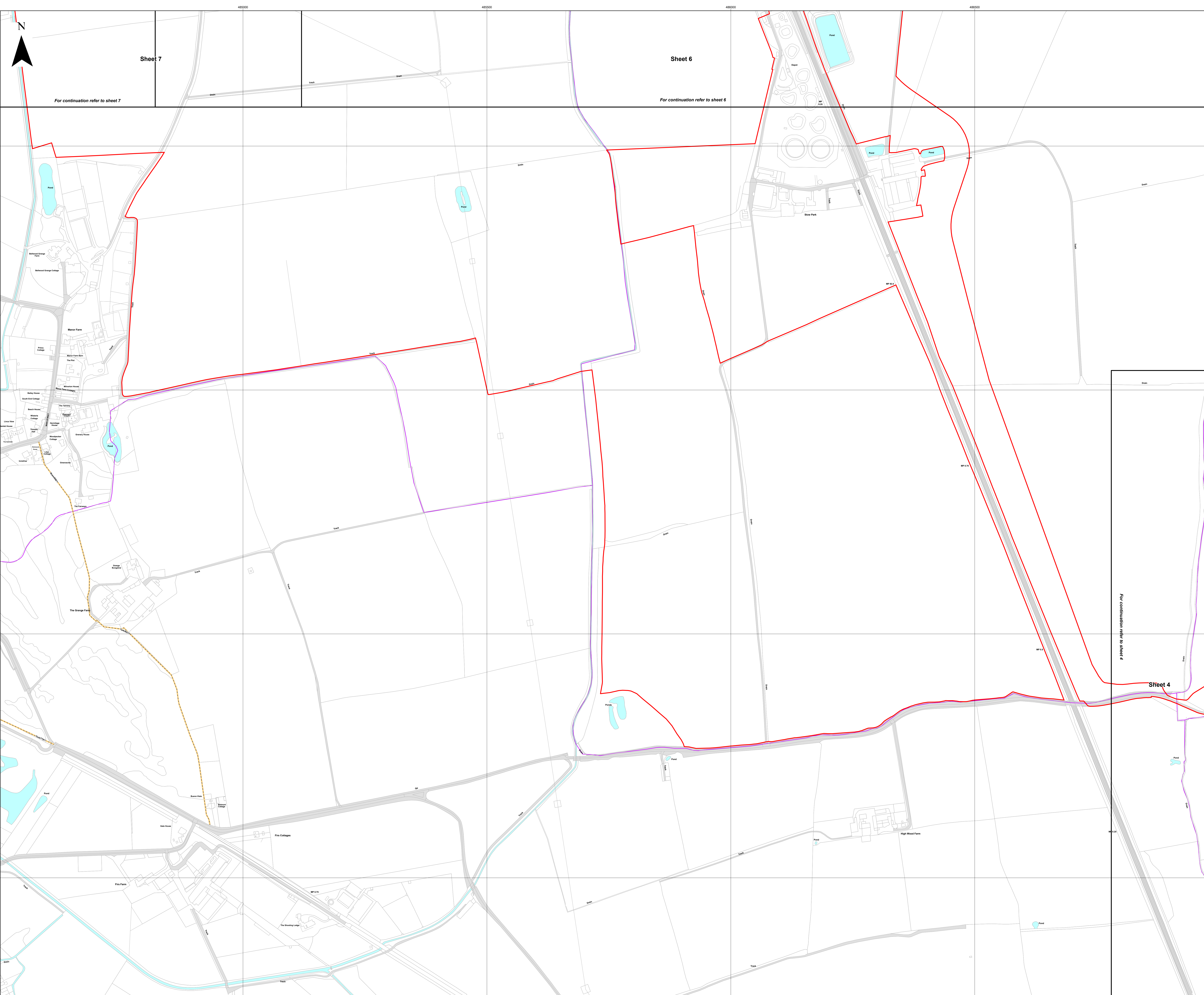

**Key**

- Order Limits
- Sheet Index
- Civil Parish Boundary
- Potential PRow Diversion Area
- Public Right of Way (PRow)
- Footpath

Layers: Lincolnshire County Council, 2024; Nottinghamshire County Council, 2024; North Lincolnshire County Council, 2024; Lanpro, 2024; IGI, 2024  
 Base map: Reproduced from Ordnance Survey digital map data © Crown copyright 2024. All rights reserved. License number 0100031673

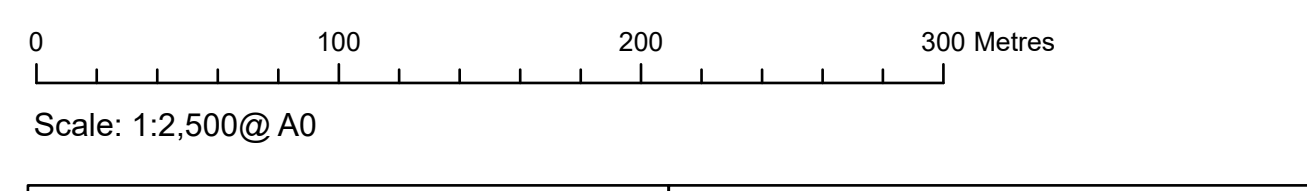

APFP Regulation: 5(2)(k)	Application Doc No. CR1/WB2.4_A
Ref: P2963_LPR_ZZ_ON_DR_Z_0210	Date: 19/01/2024
Drawn by: AZ	Checked by: JC

**Public Rights of Way Plan  
(Change Request Version)**  
Sheet 5 of 10

**WEST BURTON SOLAR PROJECT**



- Key**
- Order Limits
  - Sheet Index
  - Civil Parish Boundary
  - Potential PtO/W Diversion Area

Layers: Lincolnshire County Council, 2024; Nottinghamshire County Council, 2024; North Lincolnshire County Council, 2024; Lanpro, 2024; IGI, 2024  
Base map: Reproduced from Ordnance Survey digital map data © Crown copyright 2024. All rights reserved. License number 0100031673

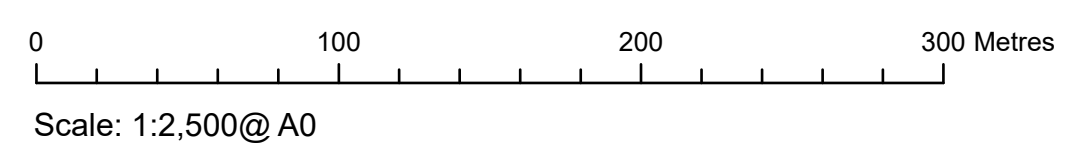

APFP Regulation: 5(2)(k)	Application Doc No. CR1/WB2.4_A
Ref: P2963_LPR_ZZ_ON_DR_Z_0210	Date: 19/01/2024
Drawn by: AZ	Checked by: JC

**Public Rights of Way Plan  
(Change Request Version)**  
Sheet 6 of 10

**WEST BURTON SOLAR PROJECT**

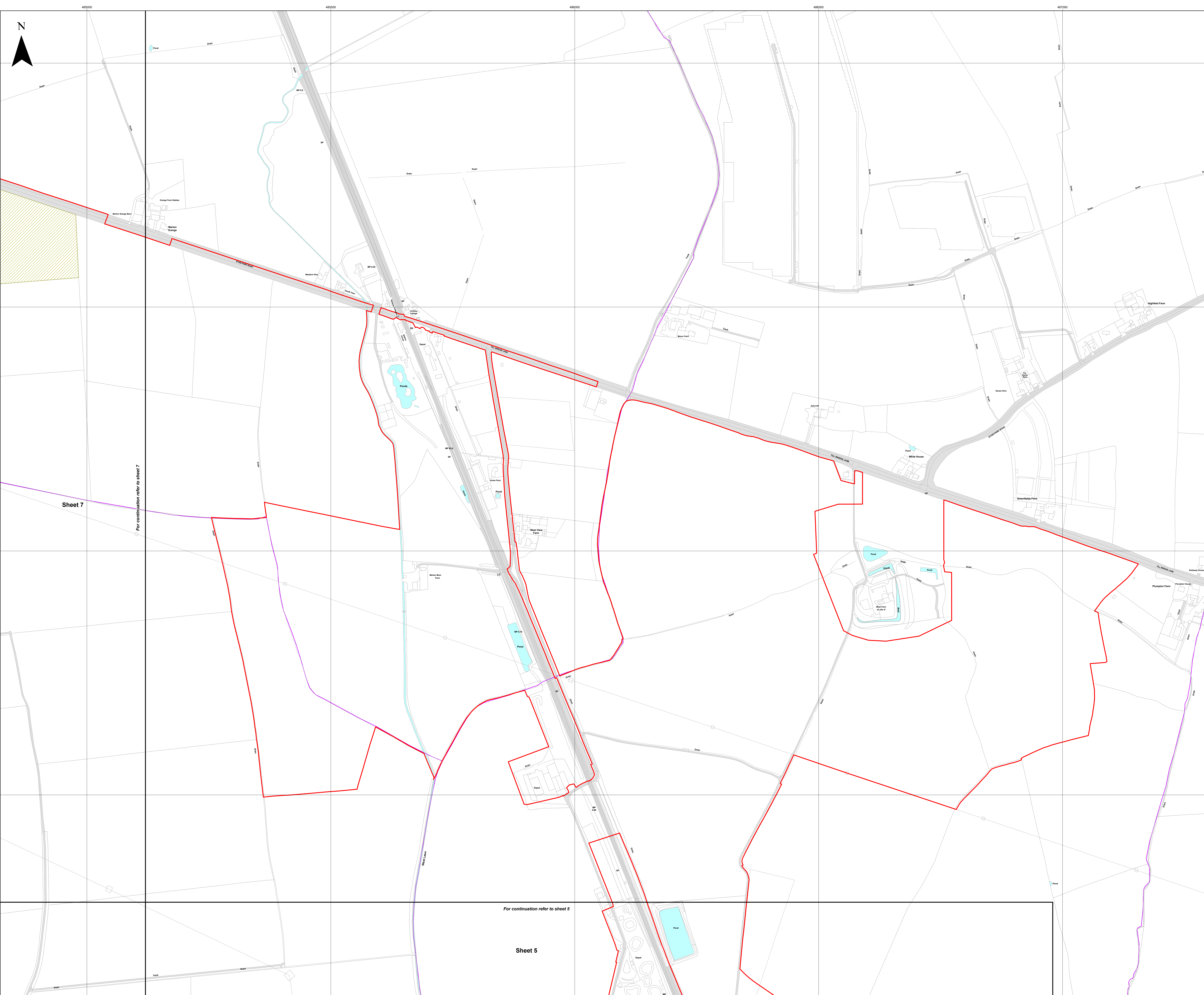

For continuation refer to sheet 7

For continuation refer to sheet 5

Sheet 7

Sheet 5



- Key**
- Order Limits
  - Sheet Index
  - Civil Parish Boundary
  - Potential PRoW Diversion Area
- Public Right of Way (PRoW)**
- Footpath
  - Bridleway
  - Byway
  - Byway Open to All Traffic
- PRoW to be temporarily stopped up**
- Byway
  - Byway Open to All Traffic
- PRoW to be temporarily stopped up - start and end points**
- Byway
  - BOAT

Layers: Lincolnshire County Council, 2024; Nottinghamshire County Council, 2024; North Lincolnshire County Council, 2024; Lanpro, 2024; IGI, 2024  
 Base map: Reproduced from Ordnance Survey digital map data © Crown copyright 2024. All rights reserved. License number 0100031673

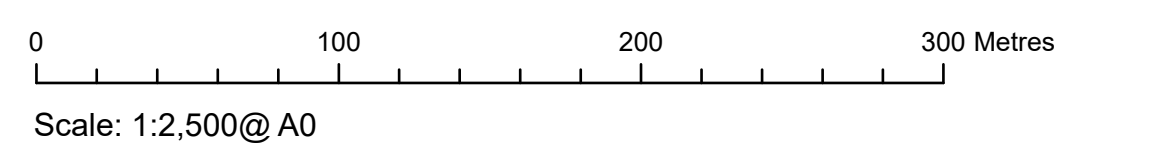

APFP Regulation: 5(2)(k)	Application Doc No. CR1/WB2.4_A
Ref: P2963_LPR_ZZ_ON_DR_Z_0210	Date: 19/01/2024
Drawn by: AZ	Checked by: JC

**Public Rights of Way Plan  
 (Change Request Version)**  
 Sheet 8 of 10

**WEST BURTON SOLAR PROJECT**

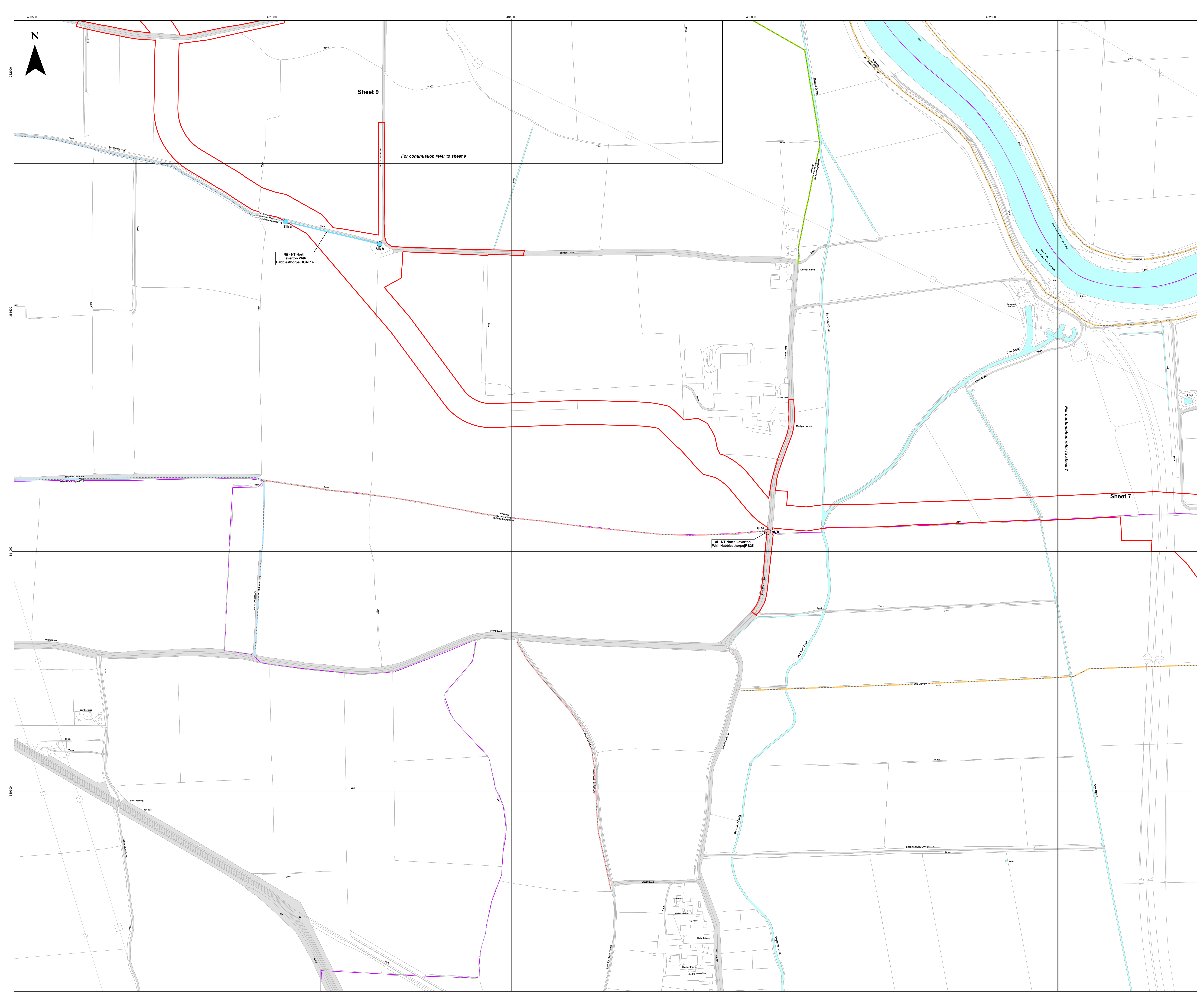



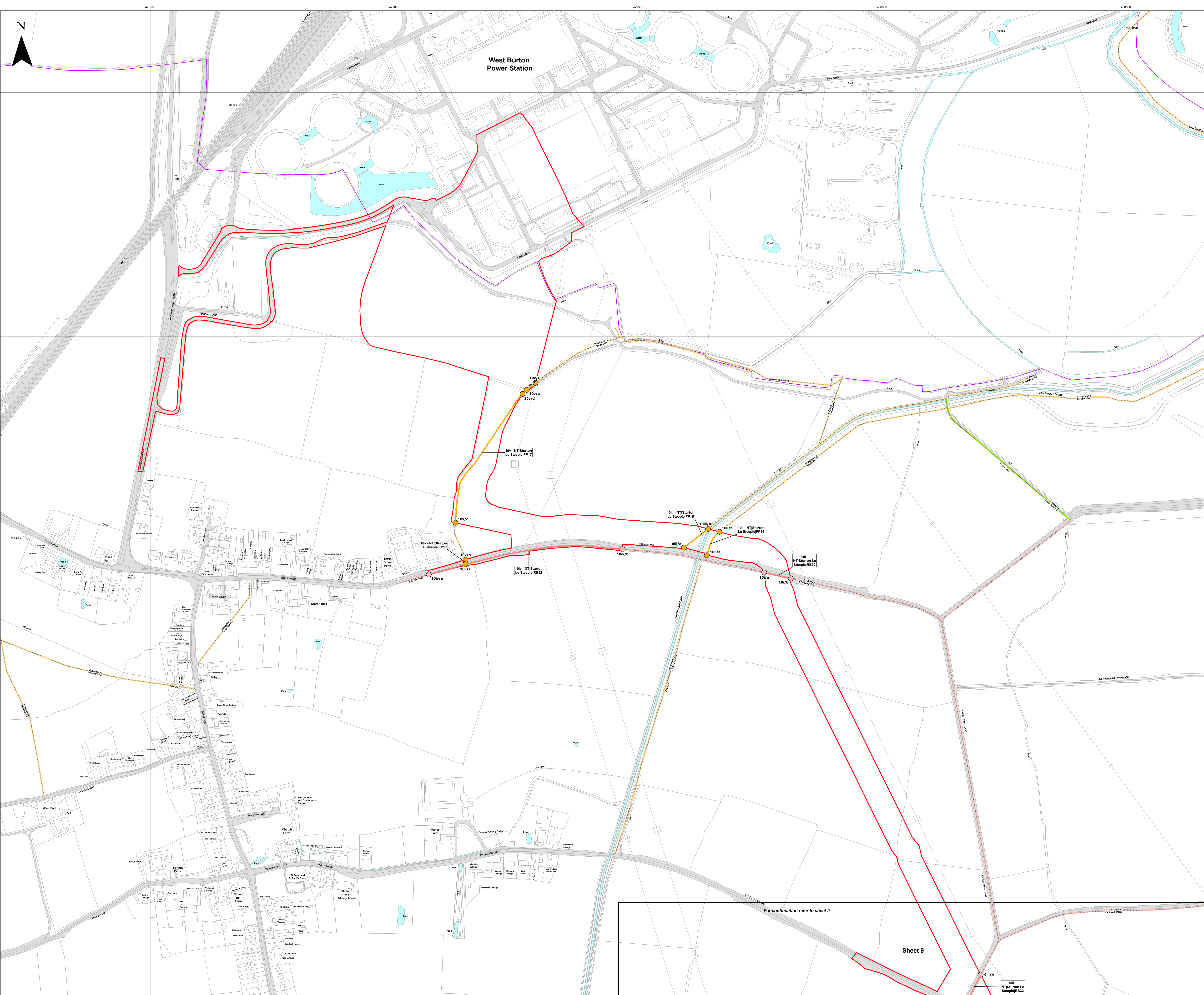

- Key**
- Order Limits
  - Sheet Index
  - Civil Parish Boundary
  - Potential PRoW Diversion Area
- Public Right of Way (PRoW)**
- Footpath
  - Bridleway
  - Byway
- PRoW to be temporarily stopped up**
- Footpath
  - Byway
- PRoW to be temporarily stopped up - start and end points**
- Footpath
  - Byway

Layers: Lincolnshire County Council, 2024; Nottinghamshire County Council, 2024; North Lincolnshire County Council, 2024; Lanpro, 2024; IGI, 2024  
 Base map: reproduced from Ordnance Survey digital map data © Crown copyright 2024. All rights reserved. Licence number 0100031673

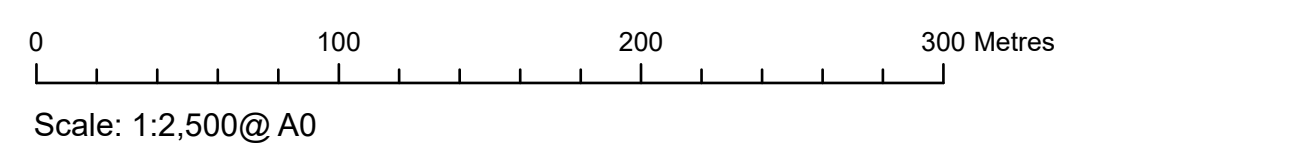

APFP Regulation: 5(2)(k)	Application Doc No. CR1/WB2.4_A
Ref: P2963_LPR_ZZ_ON_DR_Z_0210	Date: 19/01/2024
Drawn by: AZ	Checked by: JC

**Public Rights of Way Plan  
(Change Request Version)**  
Sheet 10 of 10

---

**WEST BURTON SOLAR PROJECT**